



Fluid Environment for Water Savers

CHALLENGE: Design a corporate headquarters for SSI, a U.S.-based green products manufacturer and distributor of Caroma and Fluid high-performance, water-saving fixtures.

CRITERIA: The showroom would accommodate displays of water-efficient plumbing fixtures, faucets and accessories, in addition to office space including a reception area, five offices, five open-area workstations, a conference

room with furnishings adaptable to a training environment with flexible product display areas, a fully functioning kitchen and a bathroom that serves as a space to showcase plumbing products.

INFLUENCES: SSI engaged green design firm Penner & Assocs. to oversee and implement the project's overall design. "SSI is about conservation without compromise," says SSI President Glenn Sheargold. "It has always been our

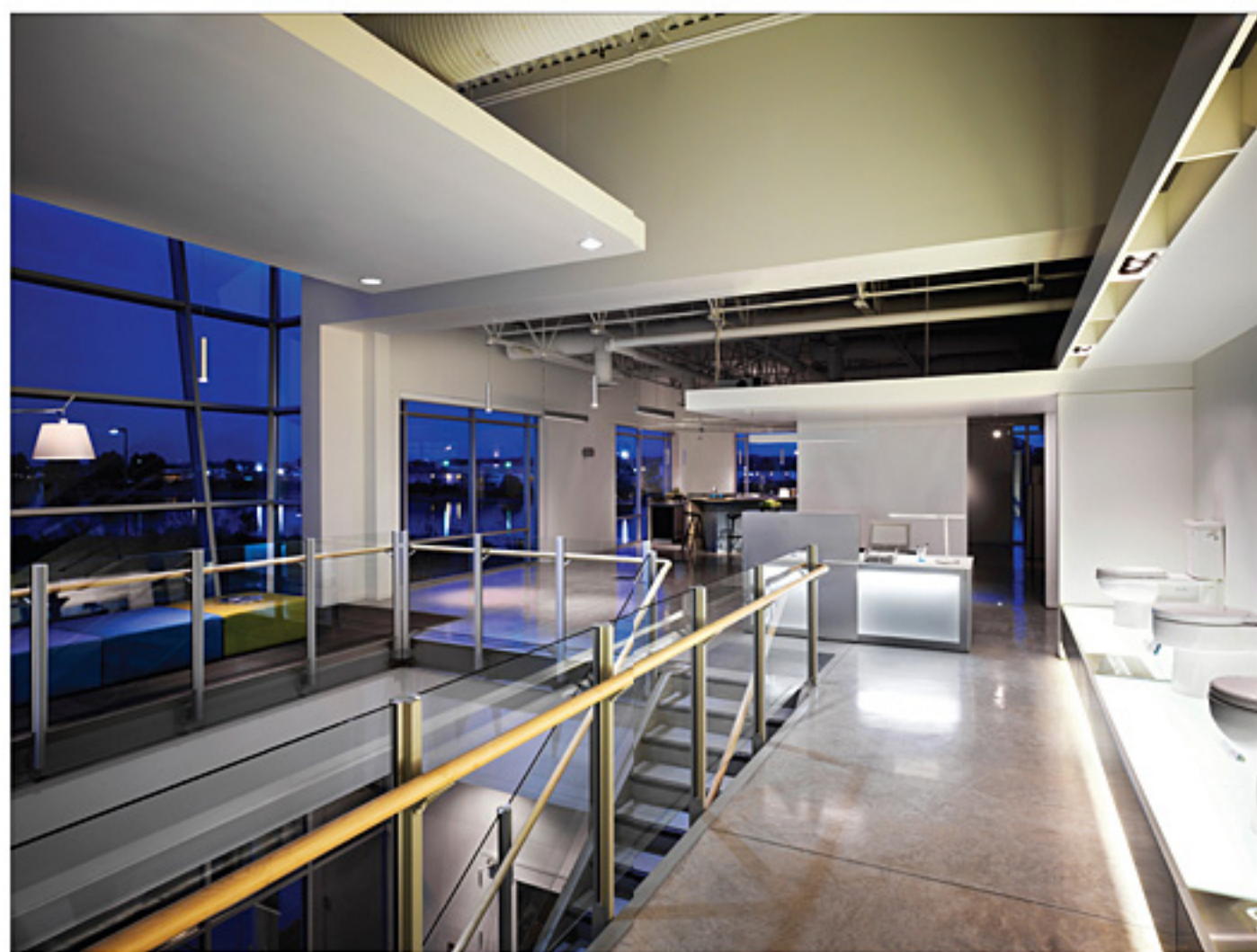

goal to bring the highest quality levels of design and technology to our product slate in a way that does not negatively impact the environment."

Shelley Penner, director of practice for the firm, was keen to maintain access to daylight and a view of the Fraser River while reducing environmental impact of construction and operations. She also wanted to establish a brand identity for SSI and one of their leading product lines, Fluid.

Penner's design concept included a completely open space with adjustable linear fluorescent and halogen lighting and flexible product displays. Penner also employed daylight and occupancy sensors to conserve energy. Retractable screens provide separation from the open display and office areas. Each workstation has seated views of the river and PVC-free blinds to reduce heat gain and control glare. She chose Energy Star-rated appliances and equipment, and GreenGuard IAQ-certified furniture and seating—Steelcase Think task chairs with 37% recycled content, bamboo content in seat fabric. Other sustainable choices during the build-out included waste and IAQ management and the purchase of green power.

SOLUTION: The influence of the SSI's corporate culture and environmentally conscious building materials led Penner to specify several of SSI's own line of water-

SUSTAINABLE SOLUTIONS INTERNATIONAL, Burnaby, B.C.

conserving plumbing fixtures. With a motto of conservation without compromise, it comes as no surprise that the bathroom fixtures represent the confluence of nature, design and technology. Penner selected floating sinks and sleek faucet fixtures from Fluid's Sublime Series Single Lever Lavatory Set. Fashioned in the shape of a semi-arc rainbow, the gently curved spout makes it the ideal fixture for vessel sinks of various heights and shapes as well as architectural basins. The contemporary sink is Caroma's Adelaide and the toilet is Caroma's Caravelle one-piece, EPA-certified high-efficiency toilet. Finally, the dramatic countertop is a customized creation with stainless-steel legs and acrylic top.

By employing its own line of elegant yet water-sensible products at its 4,200 sq. ft. corporate headquarters in Burnaby, B.C., SSI exceeds codes and client expectations. A paradigm of cutting-edge sustainable building practices and green design, the facility has been feted with a Silver Award of Excellence from the Interior Designers Institute of British Columbia. The interior installation is also attempting LEED-CI Gold certification. Visit sustainable.solutions.com or fluidfaucets.com or Circle 445

Handles Heavy Loads

Workstation Brackets

A.D.A. brackets for work stations and storage shelves are made of high quality 1/8-in. steel with a load limit that exceeds 1,000 lbs. Packaged in equal quantities of rights and lefts, the brackets are available in black, white, gray or an almond kinkle powder coat in the following sizes:

- 24 x 29" • 24 x 24"
- 18 x 24" • 15 x 21"
- 12 x 18" • 8 x 12"
- 5 x 8"

A primer coat is also available for your painted finish.

Inventory of 100,000 in stock

NEW: STAINLESS STEEL BRACKETS

- 8 x 12" • 15 x 21"
- 18 x 24"

*Prices range from \$3.10 to \$18.90

*Stainless Steel Bracket prices range from \$12.75 to \$39.95

A&M HARDWARE, INC.

400 W. Gramby Street • Manheim, PA 17545 • Phone: 888-647-0200 • Fax: 717-664-4582

www.AandMhardware.com

Circle 78



Sustainable Vision

Looking for an environmentally responsible roofing solution?

- High-performance roofing solutions with life-time warranties
- ENERGY STAR® qualified restorations and enhancements
- Eco-friendly maintenance and repair solutions
- Integrated rooftop solutions incorporating solar

The Garland Company, Inc.
800-741-3157 • www.garlandco.com

